

Madison, Wisconsin

# CITY OF MADISON

## CITY ENGINEERING DIVISION

### DEPARTMENT OF PUBLIC WORKS

# PLAN OF PROPOSED IMPROVEMENT

PUBLIC IMPROVEMENT PROJECT APPROVED

January 19, 2021

BY THE COMMON COUNCIL OF MADISON, WISCONSIN

PUBLIC IMPROVEMENT DESIGN APPROVED BY:

*Greg Fries* 02/01/2021  
City Engineer Date

STREET DESIGNED BY:

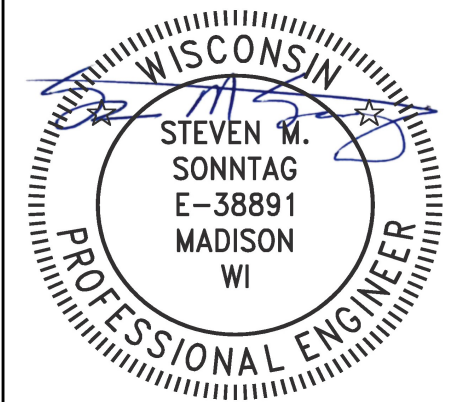

INDEX OF SHEETS

SHEET NO.	TITLE
1	1
D-1	DETAIL
P1-P12	PLAN & PROFILE
M1-M9	PAVEMENT MARKING

## SOUTH PARK STREET CONCRETE PAVEMENT REPAIRS – 2021

CITY PROJECT NO. 11132  
8578

### CONSTRUCTION PROJECT LOCATION

CONVENTIONAL SIGNS	
FIELD VERIFY ALL UTILITY LOCATIONS	
GAS	— G —
STORM SEWER	— ST —
SANITARY SEWER	— SAN —
WATER	— W —
OVERHEAD ELECTRIC	— OH —
POWER POLE	□
ADA COMPLIANT RAMP W/ DETECTABLE WARNING FIELD	▤

**NOTES:**  
 ALL GUTTERS SHALL DRAIN WITH A MINIMUM GRADE OF 0.50% TOWARD STORM SEWER INLETS.  
 SIDEWALK RAMPS AND CURB THRU SIDEWALK RAMPS SHALL HAVE A MAXIMUM SLOPE OF 1" PER 12". SIDEWALK AND CURB RAMPS SHALL BE CONSTRUCTED WITH A SIDE SLOPE OF 2.00%.  
 SIDEWALK SHALL HAVE A MINIMUM LONGITUDINAL SLOPE OF 0.50% AND A MAXIMUM LONGITUDINAL SLOPE OF 5.00% EXCEPT WHERE STREET GRADES EXCEED 5.00%.

EARTH WORK SUMMARY:	
ESTIMATED UNDISTRIBUTED UNDERCUT.....	90.00 C.Y.
TOTAL UNCLASSIFIED EXCAVATION CUT.....	90.00 C.Y.

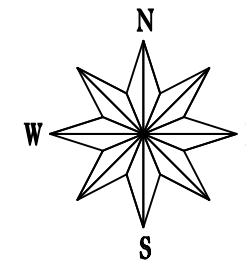
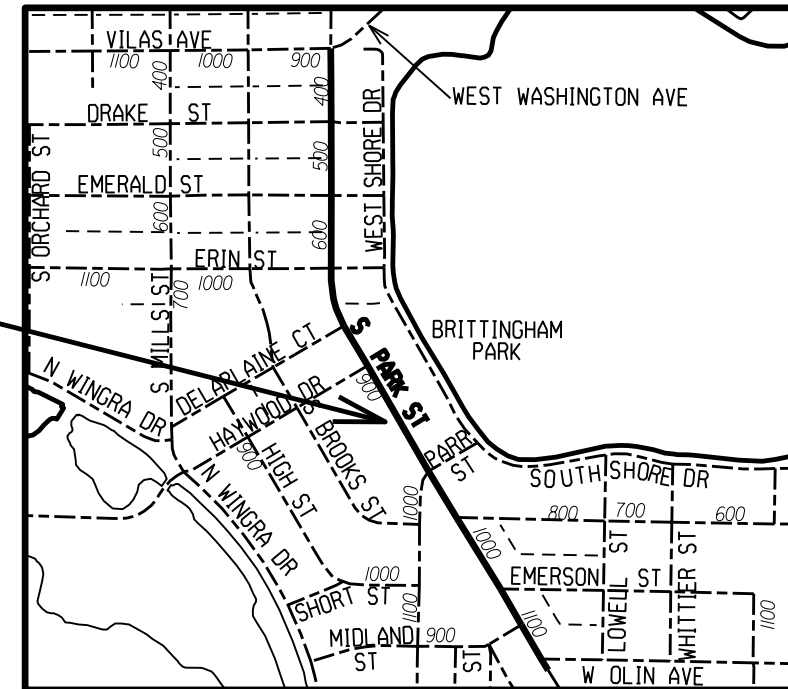
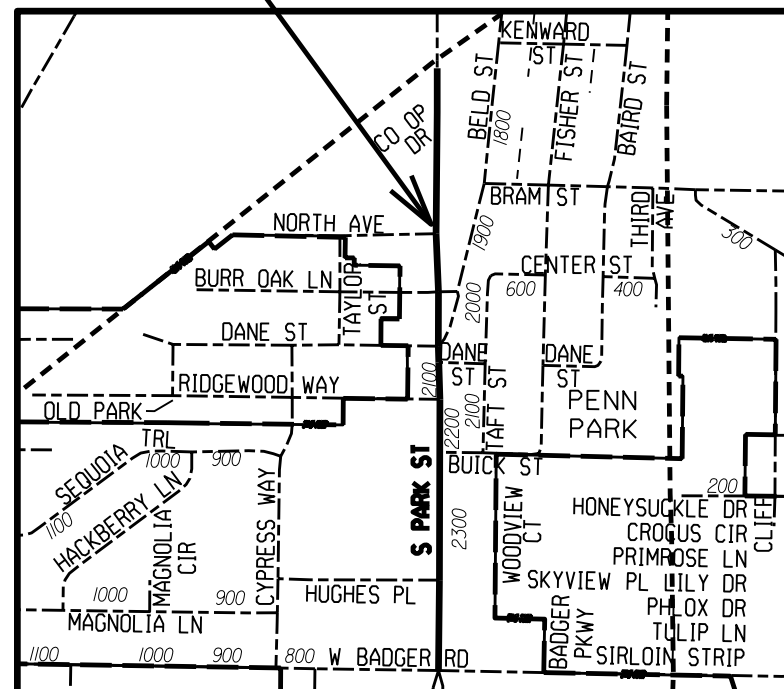

PLOT SCALE: \_\_\_\_\_

PLOT NAME: \_\_\_\_\_

REV. DATE: \_\_\_\_\_

ORIGINATOR: CITY OF MADISON, STREETS DIVISION

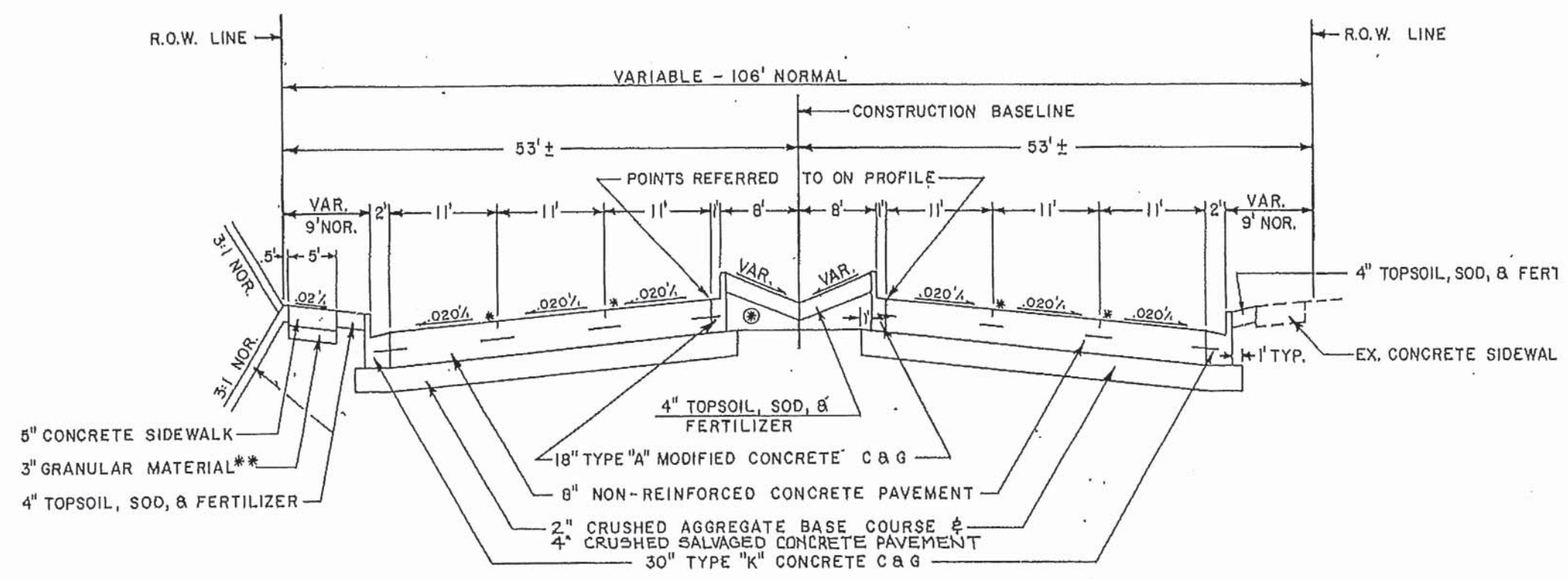

**TYPICAL SOUTH SECTION**  
**S PARK ST - W BADGER RD TO RR CROSSING**

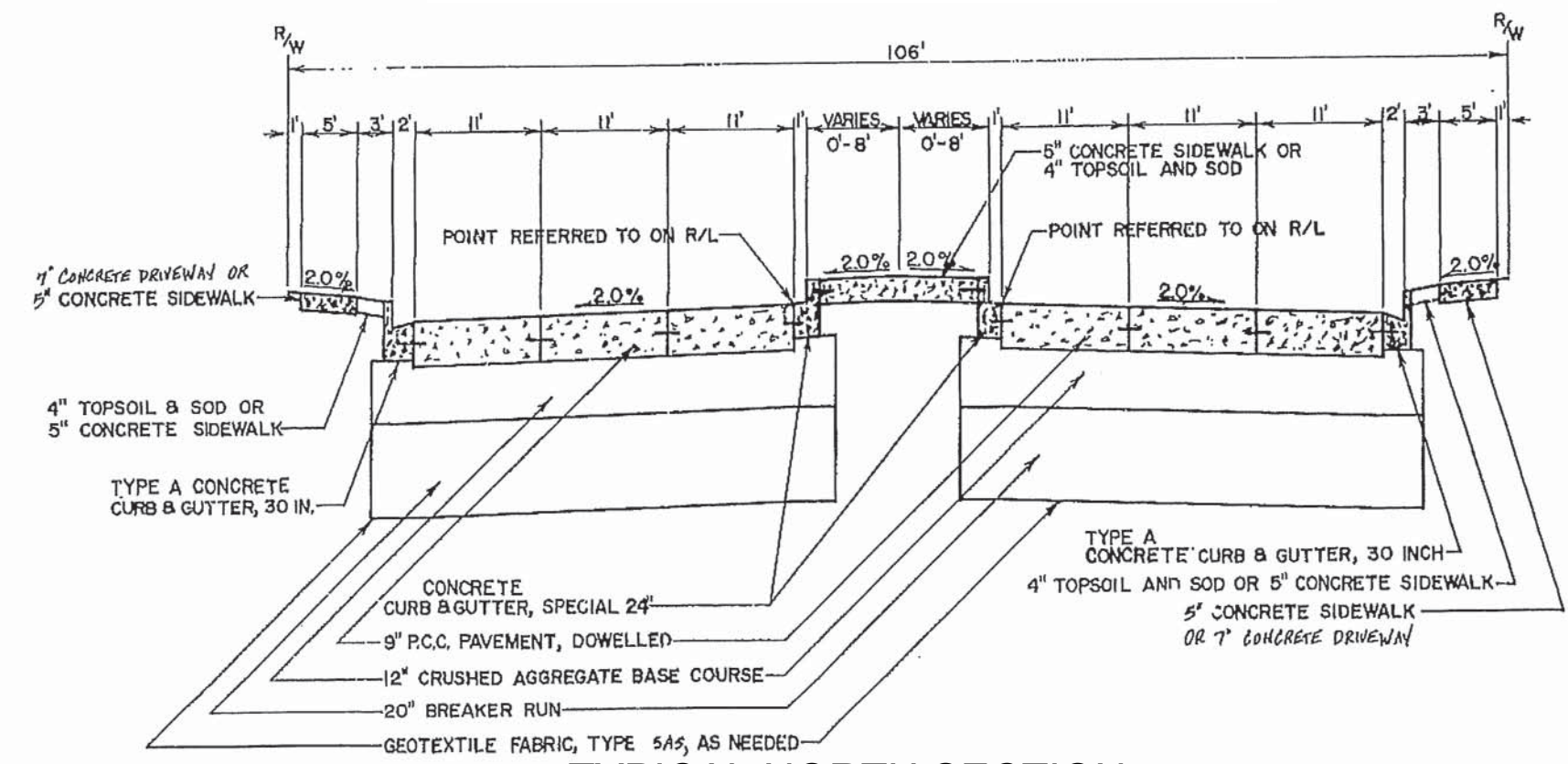

**TYPICAL NORTH SECTION**  
**S PARK ST - 100 FEET S OF W OLIN AVE TO W WASHINGTON AVE**

NOTE: ALL CROSS-HATCHED AREAS ON THE PLANS ARE  
 8 INCH OR 9 INCH CONCRETE PAVEMENT REPLACEMENT

HUGHES PLACE

ADJUST  
SAS

ADJUST  
SAS

S PARK STREET

WEST BADGER ROAD

2401

04-0

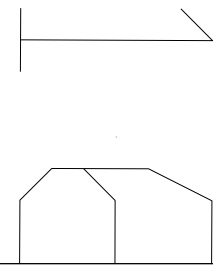

05-8

2413

2421

02-4

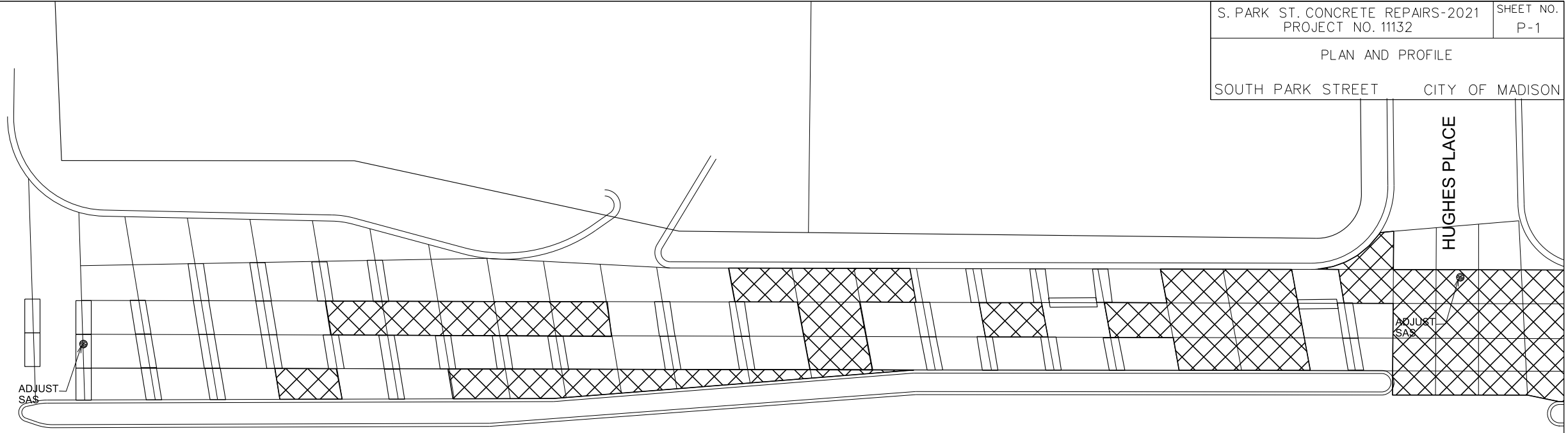
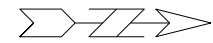

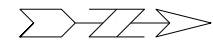

2300

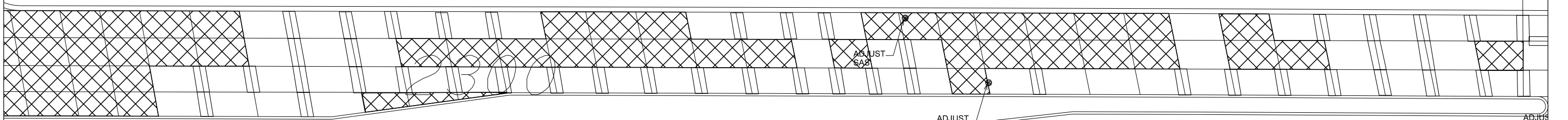

S PARK STREET

2300

ADJUST  
SAS

ADJUST  
SAS

2305

Ø3-2

23

230

Ø1-6

2209

2207

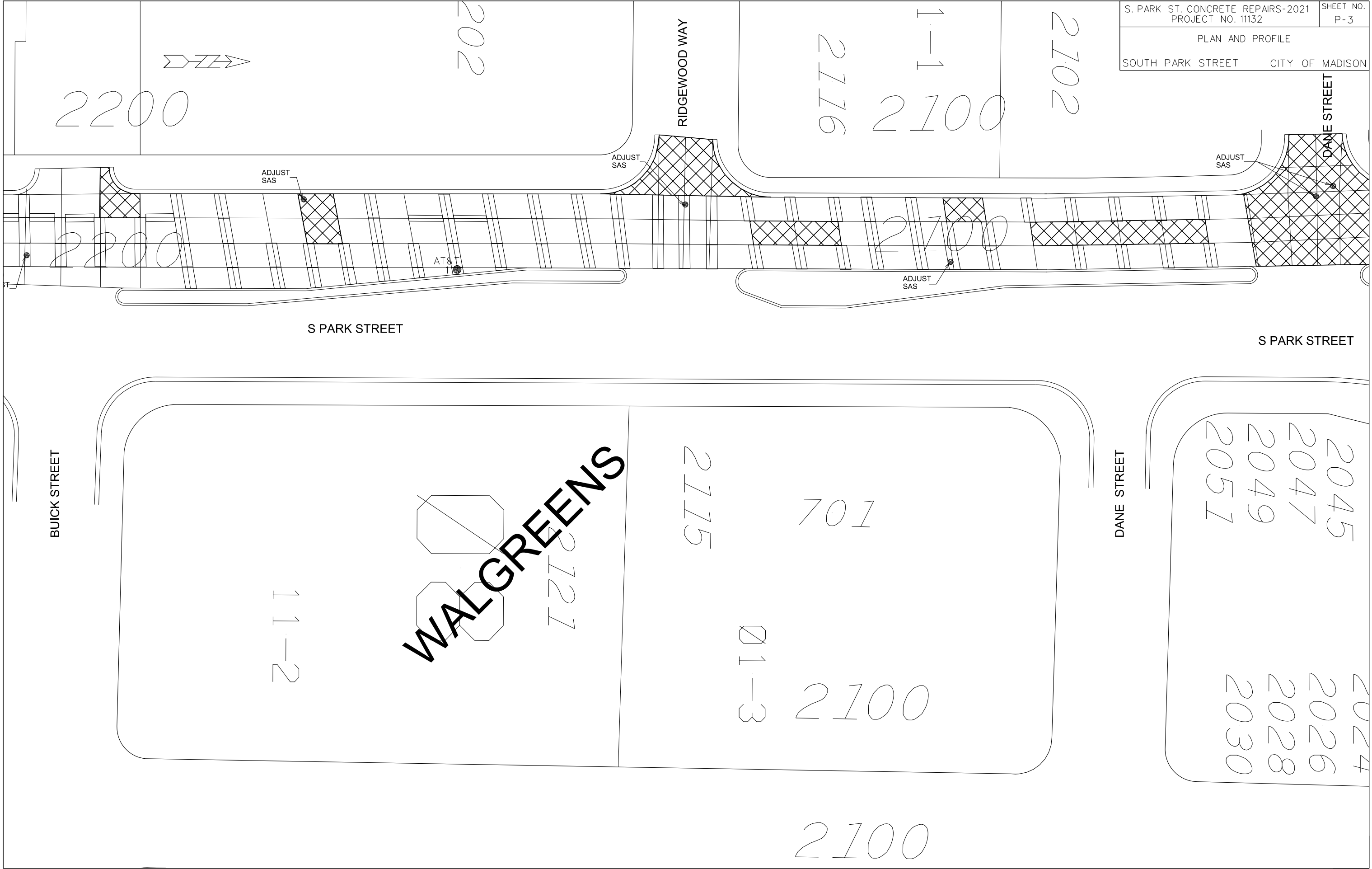

**WALGREENS**

2200

202

RIDGEWOOD WAY

2176

2100

2102

DANE STREET

S PARK STREET

S PARK STREET

BUICK STREET

DANE STREET

11-2

2121

2115

701

01-3

2100

2045  
2047  
2049  
2051

2024  
2026  
2028  
2030

2100

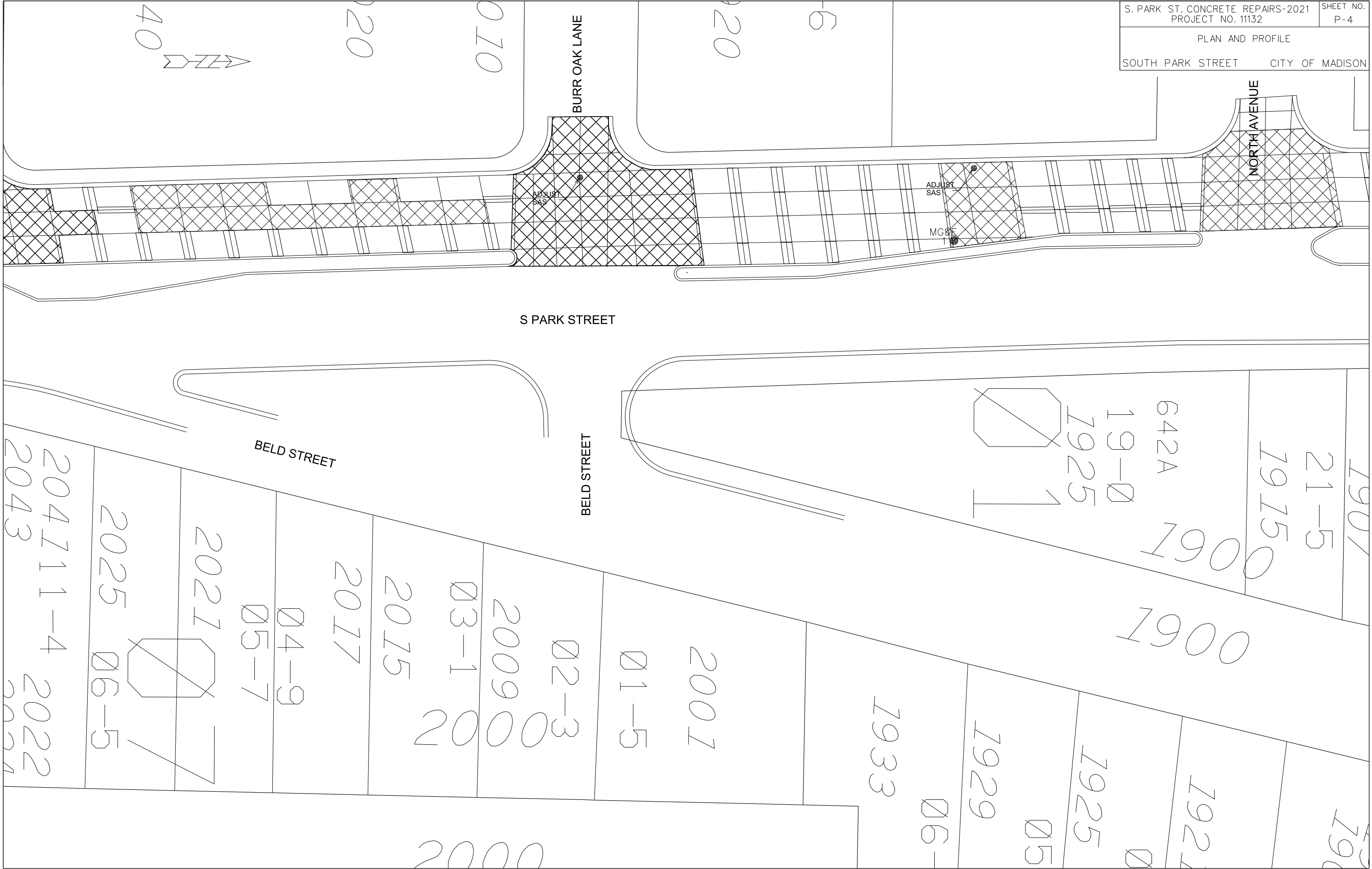

40

020  
 070

BURR OAK LANE

020  
 -6

NORTH AVENUE

S PARK STREET

BELD STREET

BELD STREET

2043  
 2041  
 111-4  
 2022

2025  
 06-5

2021

04-9  
 05-7

2017

2015

03-1  
 2009

02-3

01-5

2001

1933

1929

05

1925

1921

1915

21-5

1907

642A

19-0

1925

1900

1900

1900

2000



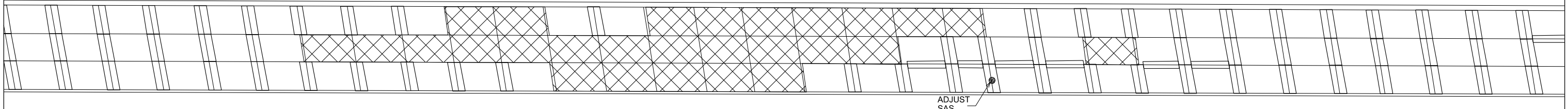
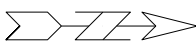

S PARK STREET

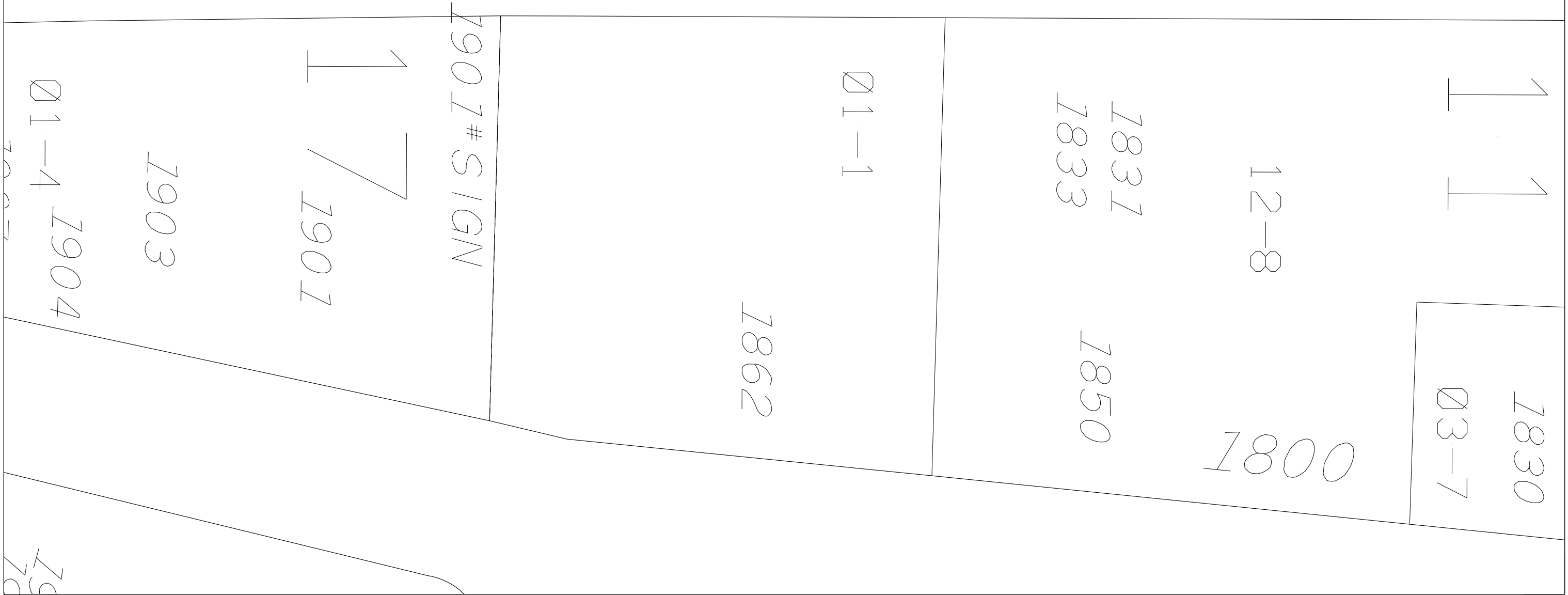

1800

1700

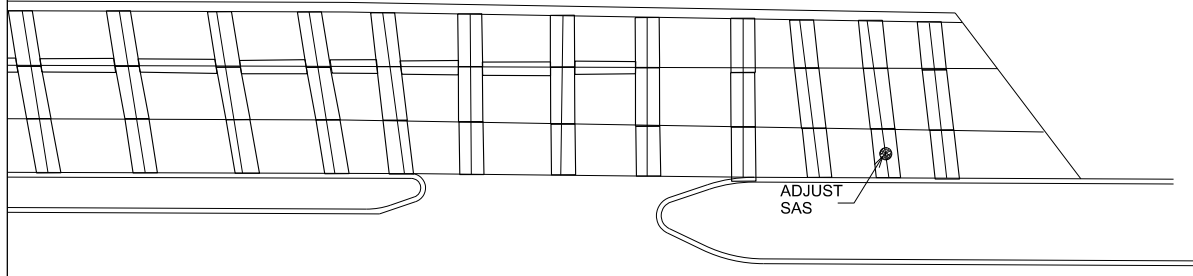

ADJUST  
SAS

S PARK STREET

1709

01-3

1823 04-5 1822

1817 10-2  
1821

1812

06-1

1810

07-9

1806

1802

14-4

18

1825

11-0



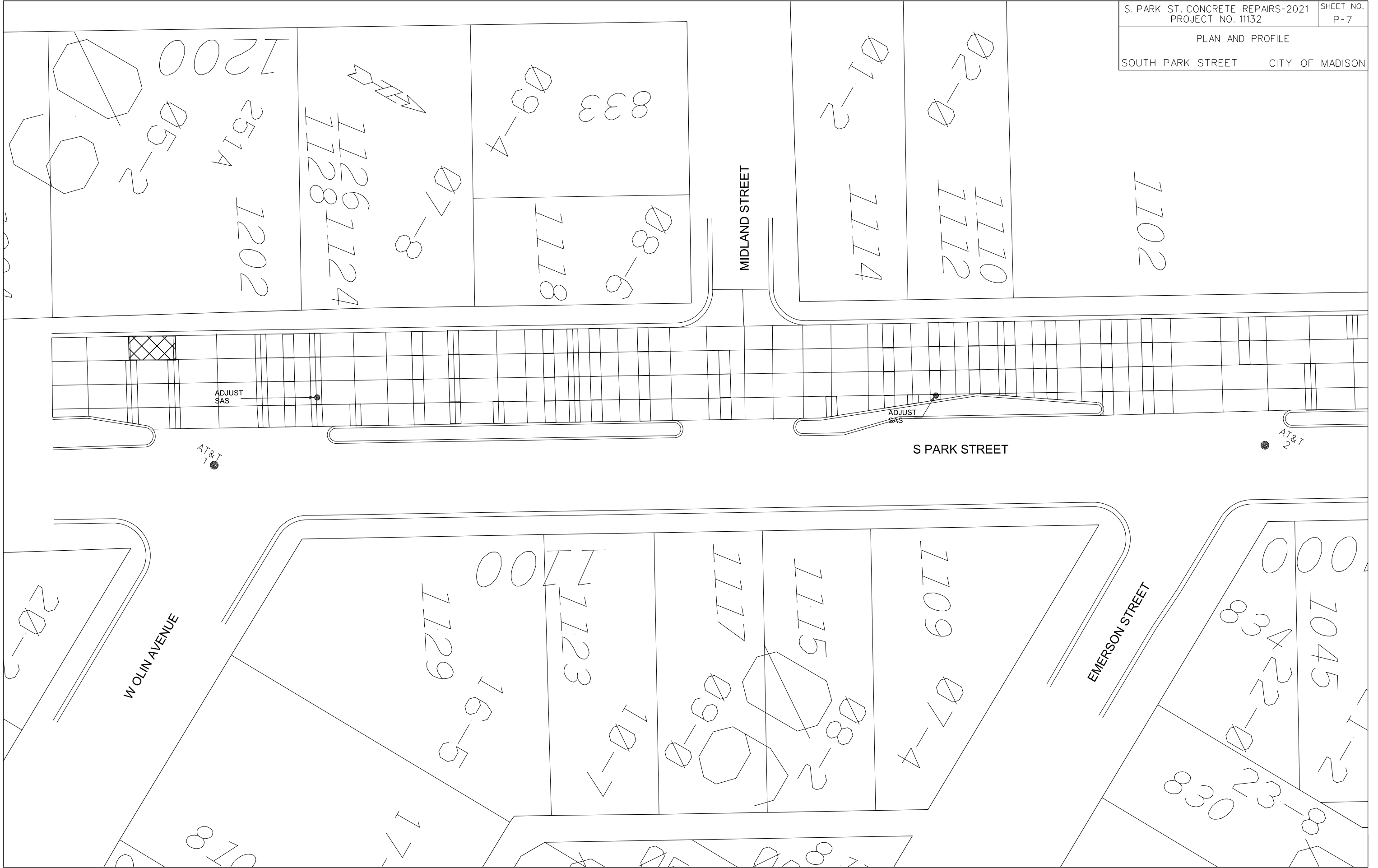

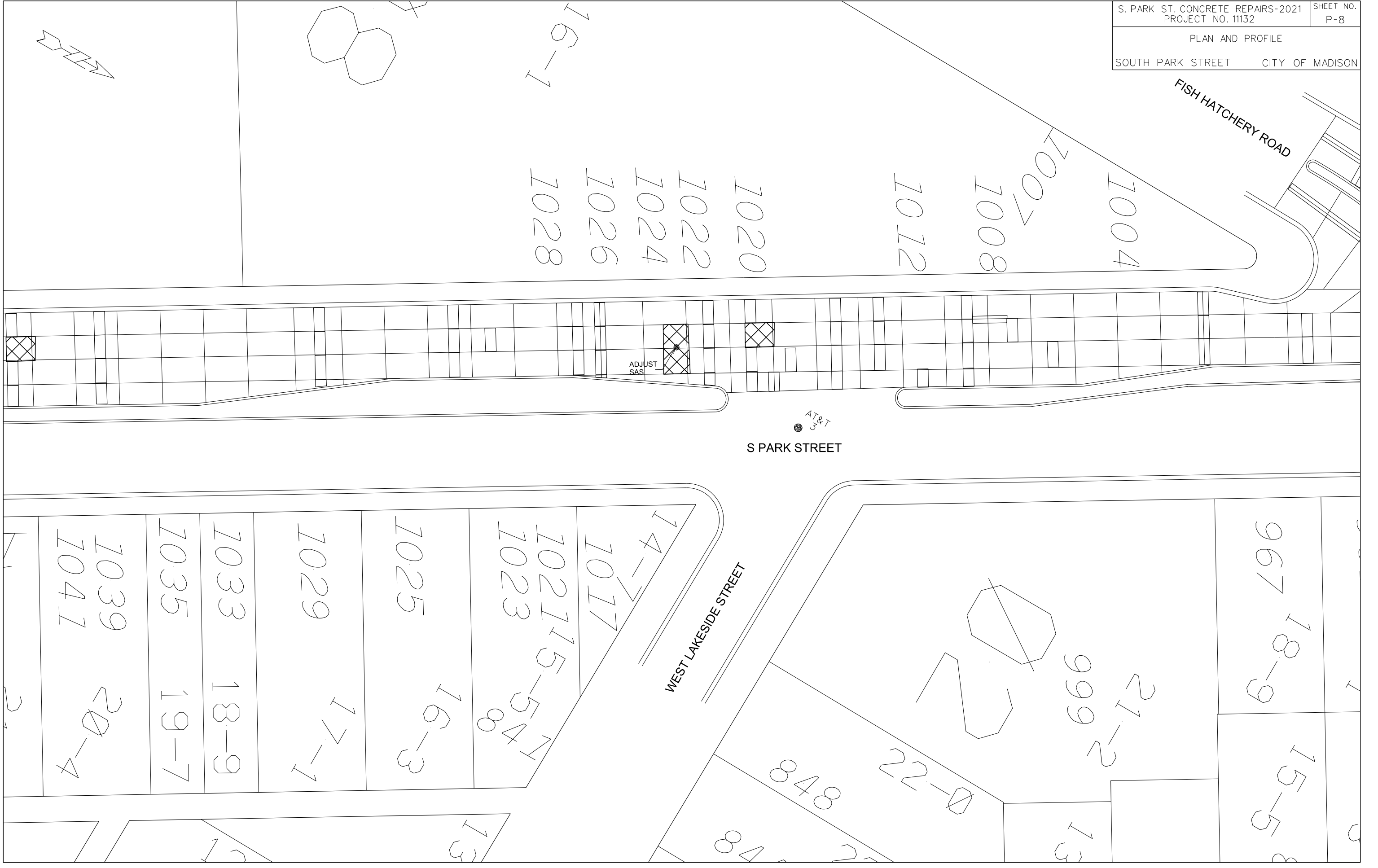

16-1  
1028  
1026  
1024  
1022  
1020  
1012  
1008  
1004  
1002

AT&T  
3  
S PARK STREET

14-7  
1017  
1021  
1023  
1025  
1029  
1033  
1035  
1039  
1041  
WEST LAKESIDE STREET  
967  
999  
15-5  
18-9  
21-2  
22-0  
848

FISH HATCHERY ROAD

ADJUST SAS

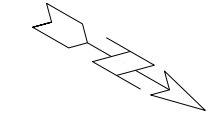

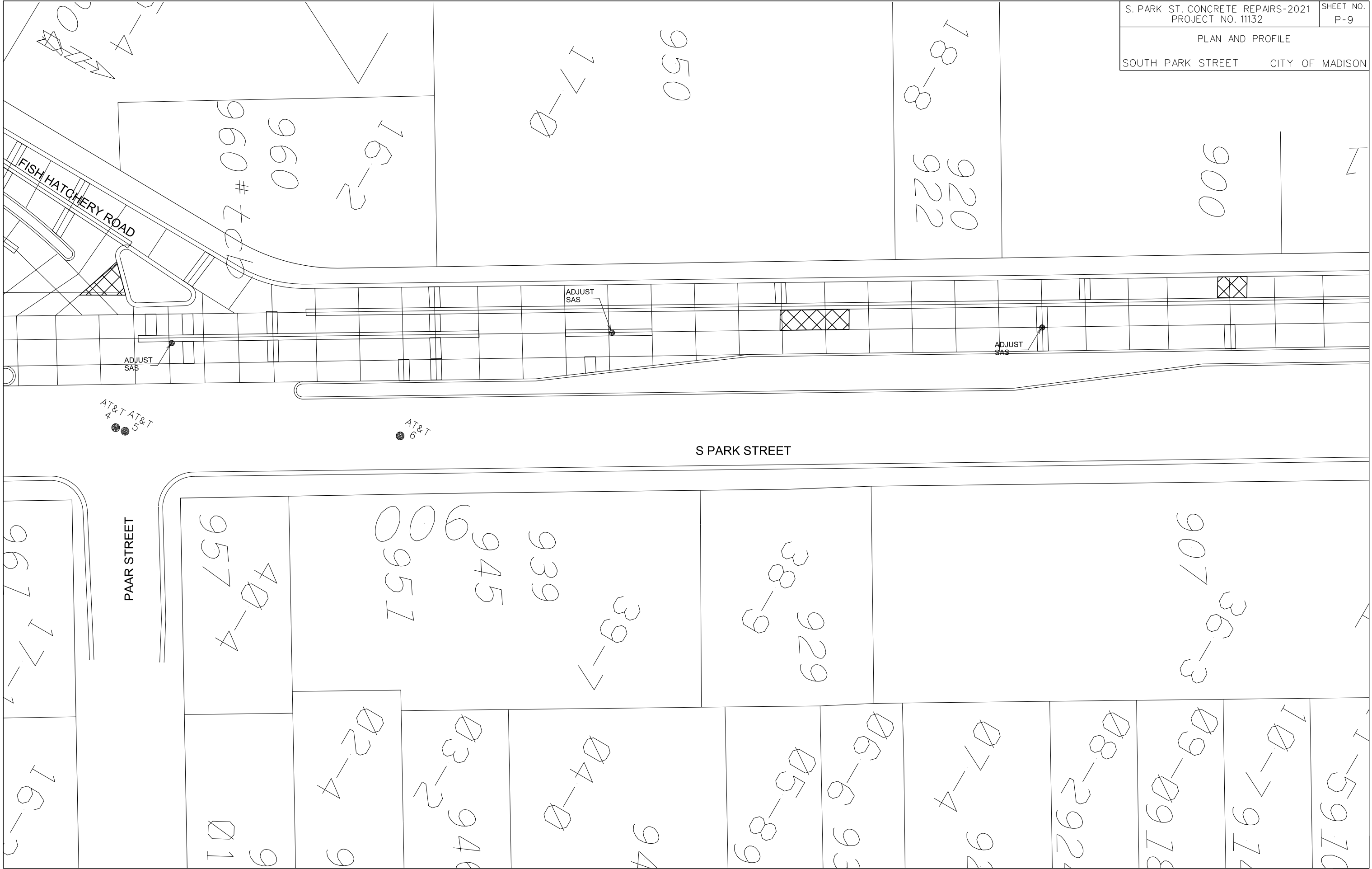



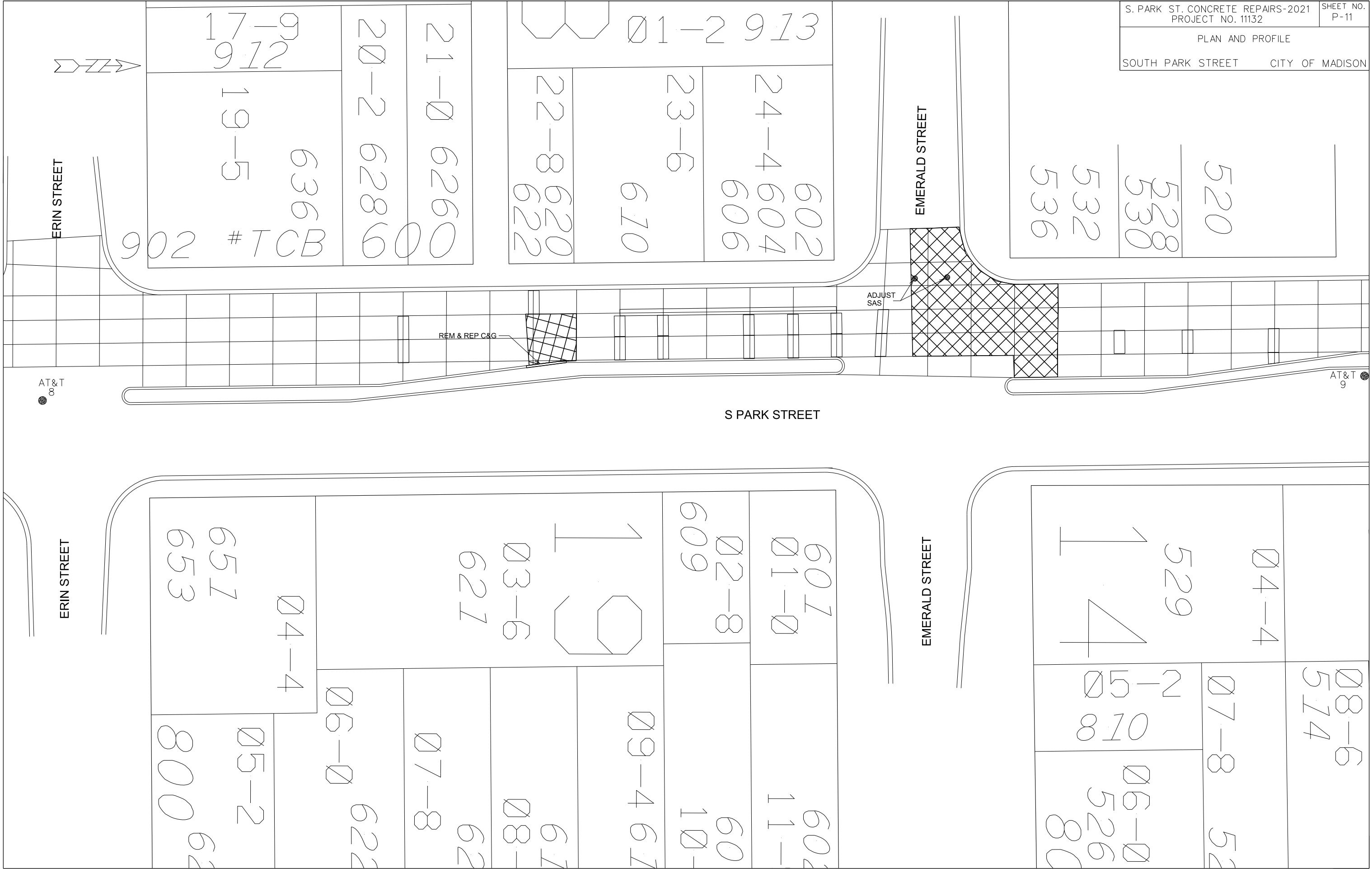

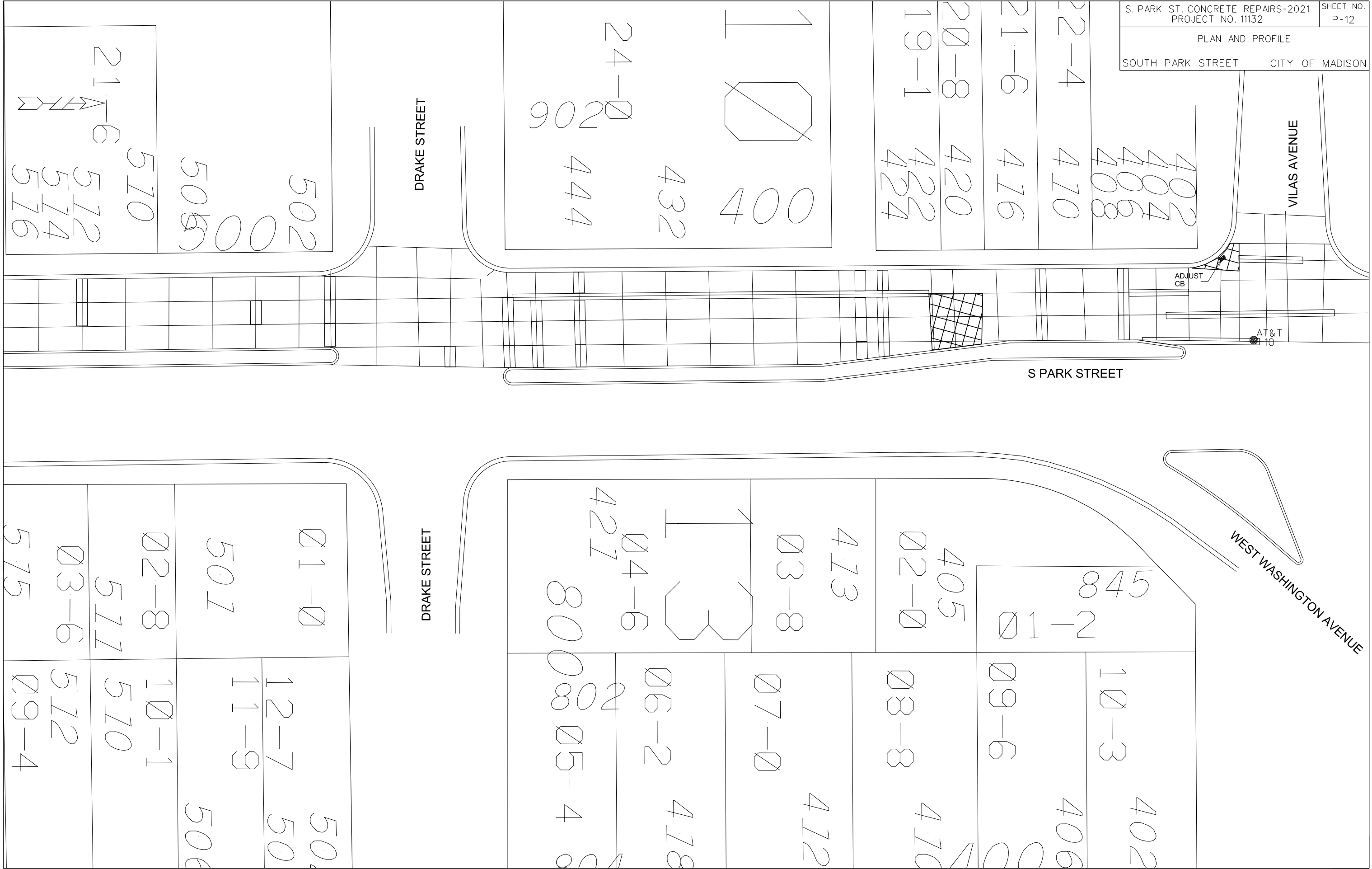



NOTES:

- TYPICAL 4' GAP BETWEEN CROSSWALK AND 24" STOP BAR
- DIMENSIONS ARE TO CENTER OF MARKING AND FACE OF CURB
- STRIPE ALL MARKINGS SHOWN IN BLACK. MOST WILL BE RE-TRACING.
- MARKINGS SHOWN AS GRAY ON THE PLAN ARE EXISTING AND SHALL NOT BE RE-MARKED.
- CONTACT TOM MOHR, CITY TRAFFIC ENGINEERING, 267-8725, TMOHR@CITYOFMADISON.COM WITH QUESTIONS

GRIND OFF EXISTING 6" CROSSWALK LINES AND INSTALL NEW CONTINENTAL-STYLE CROSSWALK

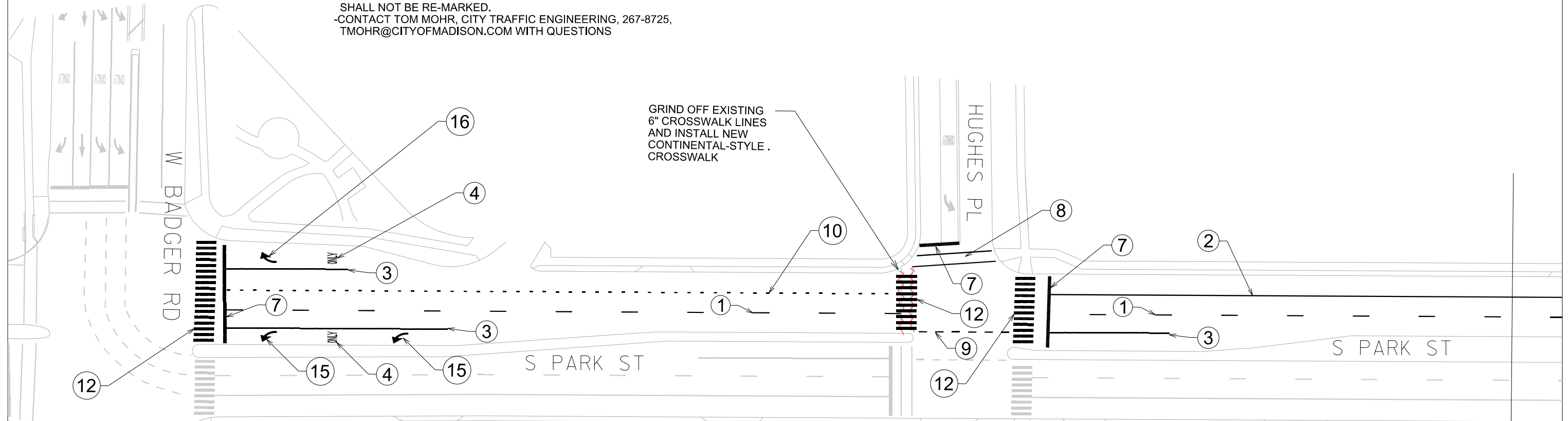

Callout	Description
1	Pavement Marking Epoxy, 6-Inch White Skips, (10' Line, 30' Gap)
2	Pavement Marking Epoxy, 6-Inch Solid White
3	Pavement Marking Epoxy, 8-Inch Solid White
4	Pavement Marking Epoxy, Word, "ONLY"
5	Pavement Marking Epoxy, Word, "BUS"
6	Pavement Marking Epoxy, Word, "BIKE"
7	Pavement Marking Epoxy, 24-Inch White, Stop Line
8	Pavement Marking Epoxy, 6-Inch White, Crosswalk
9	Pavement Marking Epoxy, 8-Inch White Skips (5' Line, 5' Gap)
10	Pavement Marking Epoxy, 6-Inch White Skips, (2' Line, 6' Gap)
11	Pavement Marking Epoxy, 6-Inch White Skips, (5' Line, 5' Gap)
12	Pavement Marking Epoxy, Continental Crosswalk
13	Pavement Marking Epoxy, Symbol, Bike Lane
14	Pavement Marking Epoxy, Symbol, Sharrow
15	Pavement Marking Epoxy, Symbol, Left Arrow
16	Pavement Marking Epoxy, Symbol, Right Arrow

MATCHLINE 1

PLOT SCALE:

PLOT NAME:

REV. DATE:

ORIGINATOR: CITY OF MADISON, TRAFFIC ENG. DIV.



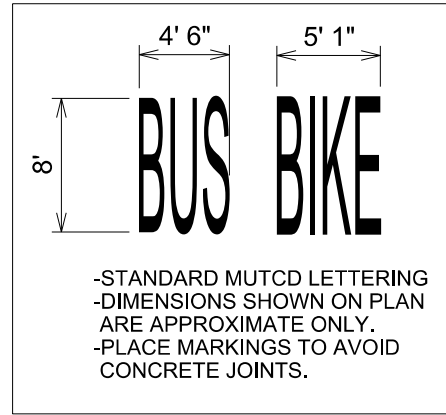

NOTES:

- TYPICAL 4' GAP BETWEEN CROSSWALK AND 24" STOP BAR
- DIMENSIONS ARE TO CENTER OF MARKING AND FACE OF CURB
- STRIPE ALL MARKINGS SHOWN IN BLACK. MOST WILL BE RE-TRACING.
- MARKINGS SHOWN AS GRAY ON THE PLAN ARE EXISTING AND SHALL NOT BE RE-MARKED.
- CONTACT TOM MOHR, CITY TRAFFIC ENGINEERING, 267-8725, TMOHR@CITYOFMADISON.COM WITH QUESTIONS

PLOT SCALE:

PLOT NAME:

REV. DATE:

ORIGINATOR: CITY OF MADISON, TRAFFIC ENG. DIV.

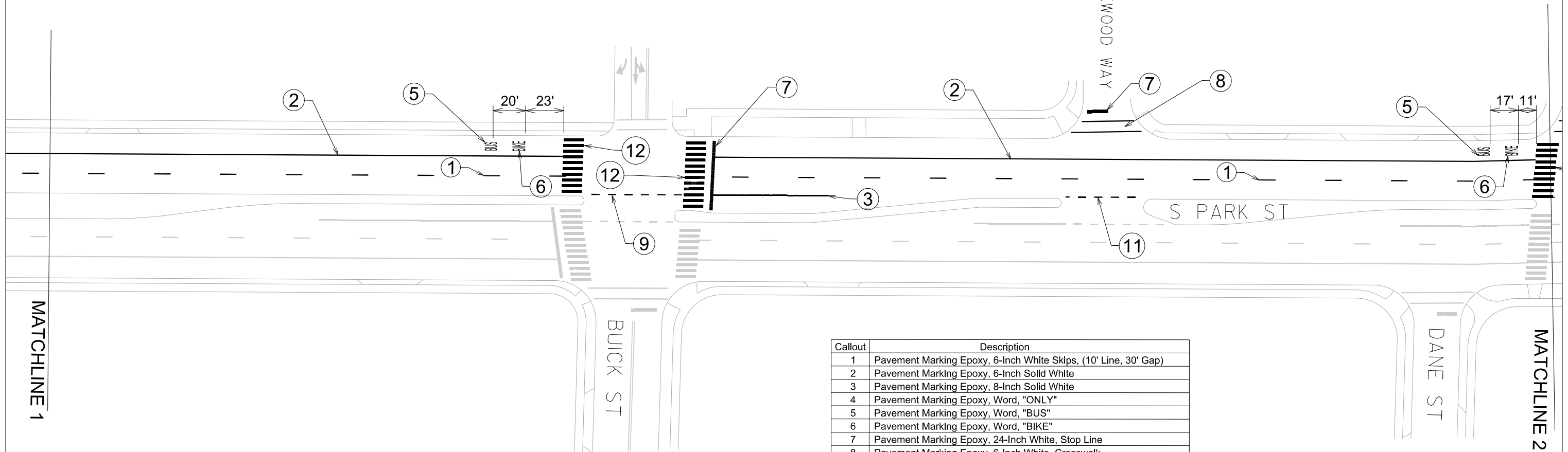

Callout	Description
1	Pavement Marking Epoxy, 6-Inch White Skips, (10' Line, 30' Gap)
2	Pavement Marking Epoxy, 6-Inch Solid White
3	Pavement Marking Epoxy, 8-Inch Solid White
4	Pavement Marking Epoxy, Word, "ONLY"
5	Pavement Marking Epoxy, Word, "BUS"
6	Pavement Marking Epoxy, Word, "BIKE"
7	Pavement Marking Epoxy, 24-Inch White, Stop Line
8	Pavement Marking Epoxy, 6-Inch White, Crosswalk
9	Pavement Marking Epoxy, 8-Inch White Skips (5' Line, 5' Gap)
10	Pavement Marking Epoxy, 6-Inch White Skips, (2' Line, 6' Gap)
11	Pavement Marking Epoxy, 6-Inch White Skips, (5' Line, 5' Gap)
12	Pavement Marking Epoxy, Continental Crosswalk
13	Pavement Marking Epoxy, Symbol, Bike Lane
14	Pavement Marking Epoxy, Symbol, Sharrow
15	Pavement Marking Epoxy, Symbol, Left Arrow
16	Pavement Marking Epoxy, Symbol, Right Arrow

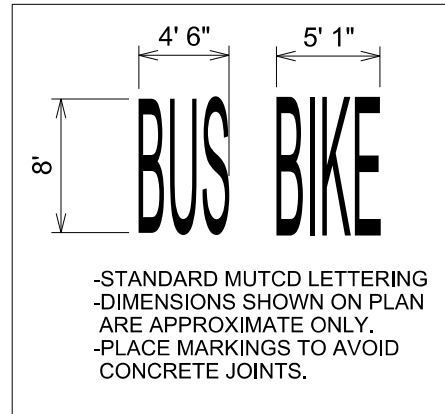

NOTES:

- TYPICAL 4' GAP BETWEEN CROSSWALK AND 24" STOP BAR
- DIMENSIONS ARE TO CENTER OF MARKING AND FACE OF CURB
- STRIPE ALL MARKINGS SHOWN IN BLACK. MOST WILL BE RE-TRACING.
- MARKINGS SHOWN AS GRAY ON THE PLAN ARE EXISTING AND SHALL NOT BE RE-MARKED.
- CONTACT TOM MOHR, CITY TRAFFIC ENGINEERING, 267-8725, TMOHR@CITYOFMADISON.COM WITH QUESTIONS

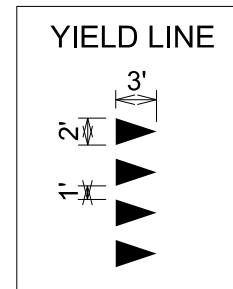

PLOT SCALE:

PLOT NAME:

REV. DATE:

ORIGINATOR: CITY OF MADISON, TRAFFIC ENG. DIV.

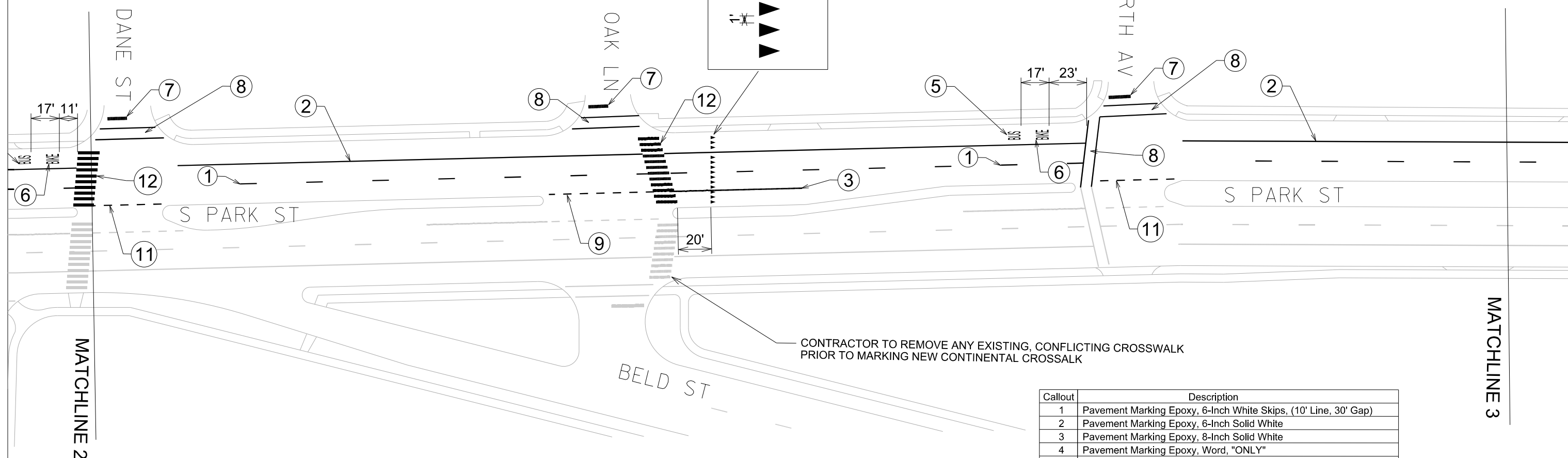

CONTRACTOR TO REMOVE ANY EXISTING, CONFLICTING CROSSWALK PRIOR TO MARKING NEW CONTINENTAL CROSSWALK

Callout	Description
1	Pavement Marking Epoxy, 6-Inch White Skips, (10' Line, 30' Gap)
2	Pavement Marking Epoxy, 6-Inch Solid White
3	Pavement Marking Epoxy, 8-Inch Solid White
4	Pavement Marking Epoxy, Word, "ONLY"
5	Pavement Marking Epoxy, Word, "BUS"
6	Pavement Marking Epoxy, Word, "BIKE"
7	Pavement Marking Epoxy, 24-Inch White, Stop Line
8	Pavement Marking Epoxy, 6-Inch White, Crosswalk
9	Pavement Marking Epoxy, 8-Inch White Skips (5' Line, 5' Gap)
10	Pavement Marking Epoxy, 6-Inch White Skips, (2' Line, 6' Gap)
11	Pavement Marking Epoxy, 6-Inch White Skips, (5' Line, 5' Gap)
12	Pavement Marking Epoxy, Continental Crosswalk
13	Pavement Marking Epoxy, Symbol, Bike Lane
14	Pavement Marking Epoxy, Symbol, Sharrow
15	Pavement Marking Epoxy, Symbol, Left Arrow
16	Pavement Marking Epoxy, Symbol, Right Arrow

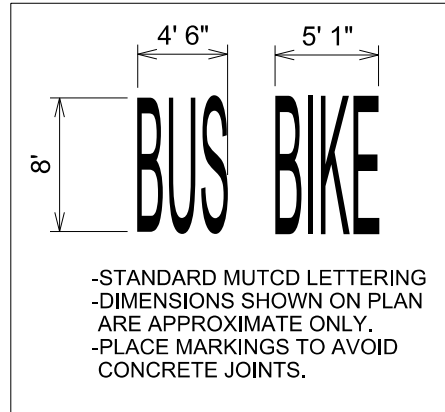

NOTES:

- TYPICAL 4' GAP BETWEEN CROSSWALK AND 24" STOP BAR
- DIMENSIONS ARE TO CENTER OF MARKING AND FACE OF CURB
- STRIPE ALL MARKINGS SHOWN IN BLACK. MOST WILL BE RE-TRACING.
- MARKINGS SHOWN AS GRAY ON THE PLAN ARE EXISTING AND SHALL NOT BE RE-MARKED.
- CONTACT TOM MOHR, CITY TRAFFIC ENGINEERING, 267-8725, TMOHR@CITYOFMADISON.COM WITH QUESTIONS

PLOT SCALE:

PLOT NAME:

REV. DATE:

ORIGINATOR: CITY OF MADISON, TRAFFIC ENG. DIV.

MATCHLINE 3

NORTH LIMITS  
OF SOUTHERN SECTION

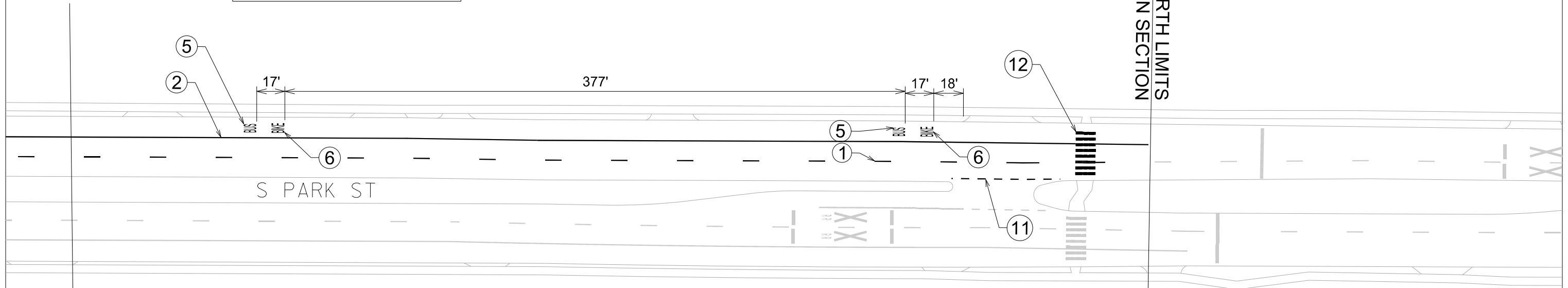

Callout	Description
1	Pavement Marking Epoxy, 6-Inch White Skips, (10' Line, 30' Gap)
2	Pavement Marking Epoxy, 6-Inch Solid White
3	Pavement Marking Epoxy, 8-Inch Solid White
4	Pavement Marking Epoxy, Word, "ONLY"
5	Pavement Marking Epoxy, Word, "BUS"
6	Pavement Marking Epoxy, Word, "BIKE"
7	Pavement Marking Epoxy, 24-Inch White, Stop Line
8	Pavement Marking Epoxy, 6-Inch White, Crosswalk
9	Pavement Marking Epoxy, 8-Inch White Skips (5' Line, 5' Gap)
10	Pavement Marking Epoxy, 6-Inch White Skips, (2' Line, 6' Gap)
11	Pavement Marking Epoxy, 6-Inch White Skips, (5' Line, 5' Gap)
12	Pavement Marking Epoxy, Continental Crosswalk
13	Pavement Marking Epoxy, Symbol, Bike Lane
14	Pavement Marking Epoxy, Symbol, Sharrow
15	Pavement Marking Epoxy, Symbol, Left Arrow
16	Pavement Marking Epoxy, Symbol, Right Arrow

NOTES:

- TYPICAL 4' GAP BETWEEN CROSSWALK AND 24" STOP BAR
- DIMENSIONS ARE TO CENTER OF MARKING AND FACE OF CURB
- STRIPE ALL MARKINGS SHOWN IN BLACK. MOST WILL BE RE-TRACING.
- MARKINGS SHOWN AS GRAY ON THE PLAN ARE EXISTING AND SHALL NOT BE RE-MARKED.
- CONTACT TOM MOHR, CITY TRAFFIC ENGINEERING, 267-8725, TMOHR@CITYOFMADISON.COM WITH QUESTIONS

PLOT SCALE:

PLOT NAME:

REV. DATE:

ORIGINATOR: CITY OF MADISON, TRAFFIC ENG. DIV.

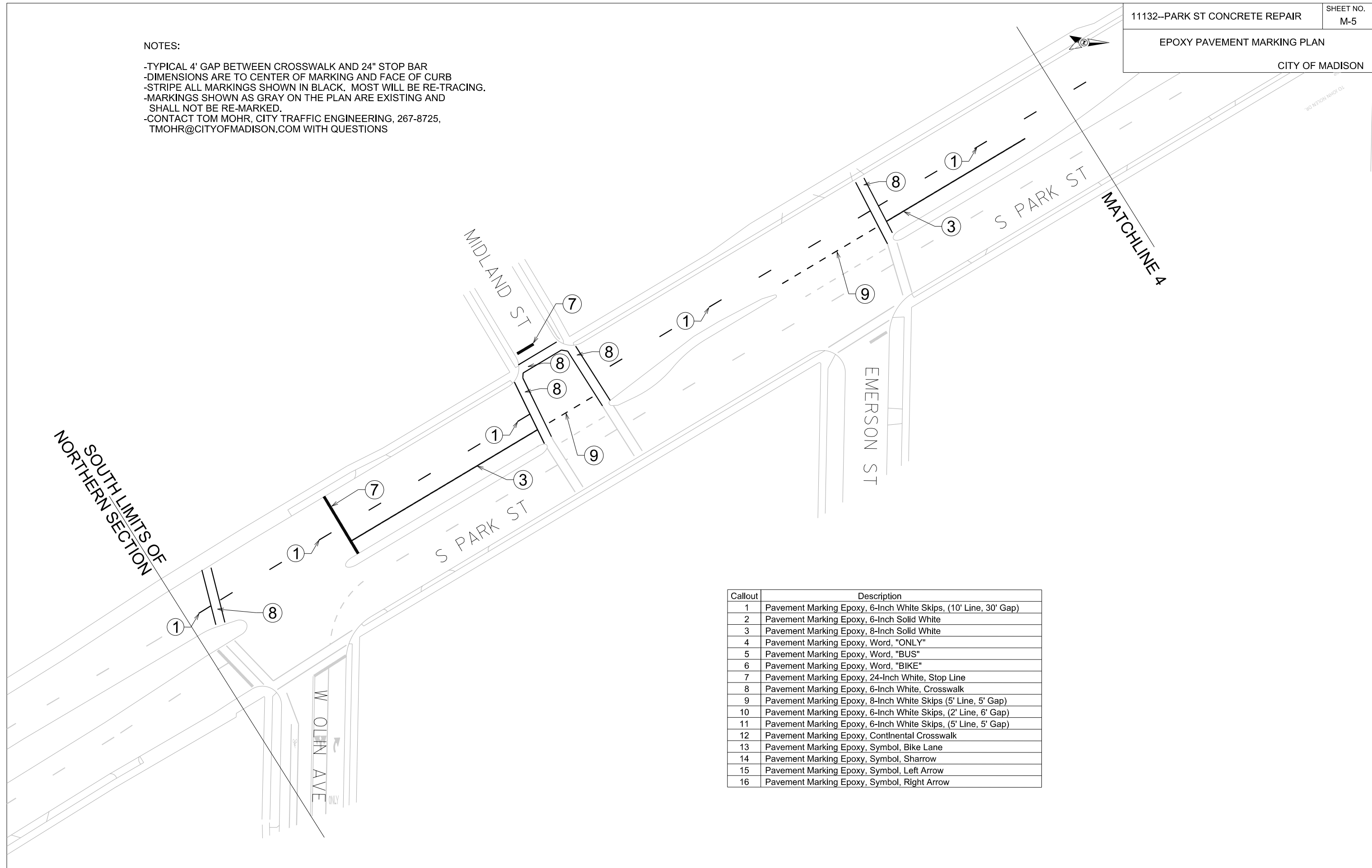

Callout	Description
1	Pavement Marking Epoxy, 6-Inch White Skips, (10' Line, 30' Gap)
2	Pavement Marking Epoxy, 6-Inch Solid White
3	Pavement Marking Epoxy, 8-Inch Solid White
4	Pavement Marking Epoxy, Word, "ONLY"
5	Pavement Marking Epoxy, Word, "BUS"
6	Pavement Marking Epoxy, Word, "BIKE"
7	Pavement Marking Epoxy, 24-Inch White, Stop Line
8	Pavement Marking Epoxy, 6-Inch White, Crosswalk
9	Pavement Marking Epoxy, 8-Inch White Skips (5' Line, 5' Gap)
10	Pavement Marking Epoxy, 6-Inch White Skips, (2' Line, 6' Gap)
11	Pavement Marking Epoxy, 6-Inch White Skips, (5' Line, 5' Gap)
12	Pavement Marking Epoxy, Continental Crosswalk
13	Pavement Marking Epoxy, Symbol, Bike Lane
14	Pavement Marking Epoxy, Symbol, Sharrow
15	Pavement Marking Epoxy, Symbol, Left Arrow
16	Pavement Marking Epoxy, Symbol, Right Arrow

FISH HATCHERY RD

NOTES:

- TYPICAL 4' GAP BETWEEN CROSSWALK AND 24" STOP BAR
- DIMENSIONS ARE TO CENTER OF MARKING AND FACE OF CURB
- STRIPE ALL MARKINGS SHOWN IN BLACK. MOST WILL BE RE-TRACING.
- MARKINGS SHOWN AS GRAY ON THE PLAN ARE EXISTING AND SHALL NOT BE RE-MARKED.
- CONTACT TOM MOHR, CITY TRAFFIC ENGINEERING, 267-8725, TMOHR@CITYOFMADISON.COM WITH QUESTIONS

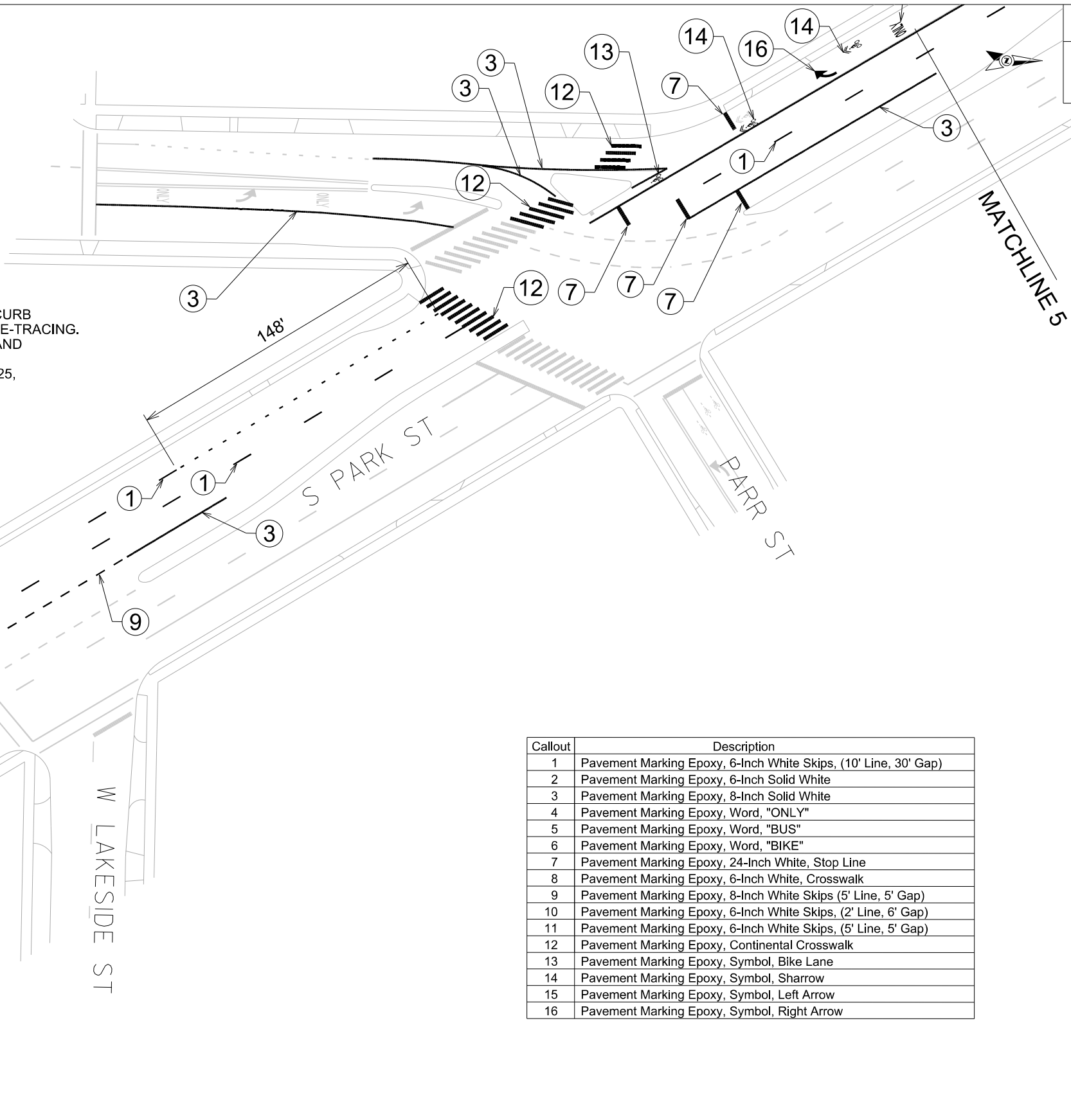

Callout	Description
1	Pavement Marking Epoxy, 6-Inch White Skips, (10' Line, 30' Gap)
2	Pavement Marking Epoxy, 6-Inch Solid White
3	Pavement Marking Epoxy, 8-Inch Solid White
4	Pavement Marking Epoxy, Word, "ONLY"
5	Pavement Marking Epoxy, Word, "BUS"
6	Pavement Marking Epoxy, Word, "BIKE"
7	Pavement Marking Epoxy, 24-Inch White, Stop Line
8	Pavement Marking Epoxy, 6-Inch White, Crosswalk
9	Pavement Marking Epoxy, 8-Inch White Skips (5' Line, 5' Gap)
10	Pavement Marking Epoxy, 6-Inch White Skips, (2' Line, 6' Gap)
11	Pavement Marking Epoxy, 6-Inch White Skips, (5' Line, 5' Gap)
12	Pavement Marking Epoxy, Continental Crosswalk
13	Pavement Marking Epoxy, Symbol, Bike Lane
14	Pavement Marking Epoxy, Symbol, Sharrow
15	Pavement Marking Epoxy, Symbol, Left Arrow
16	Pavement Marking Epoxy, Symbol, Right Arrow

PLOT SCALE:

PLOT NAME:

REV. DATE:

ORIGINATOR: CITY OF MADISON, TRAFFIC ENG. DIV.

NOTES:

- TYPICAL 4' GAP BETWEEN CROSSWALK AND 24" STOP BAR
- DIMENSIONS ARE TO CENTER OF MARKING AND FACE OF CURB
- STRIPE ALL MARKINGS SHOWN IN BLACK. MOST WILL BE RE-TRACING.
- MARKINGS SHOWN AS GRAY ON THE PLAN ARE EXISTING AND SHALL NOT BE RE-MARKED.
- CONTACT TOM MOHR, CITY TRAFFIC ENGINEERING, 267-8725, TMOHR@CITYOFMADISON.COM WITH QUESTIONS

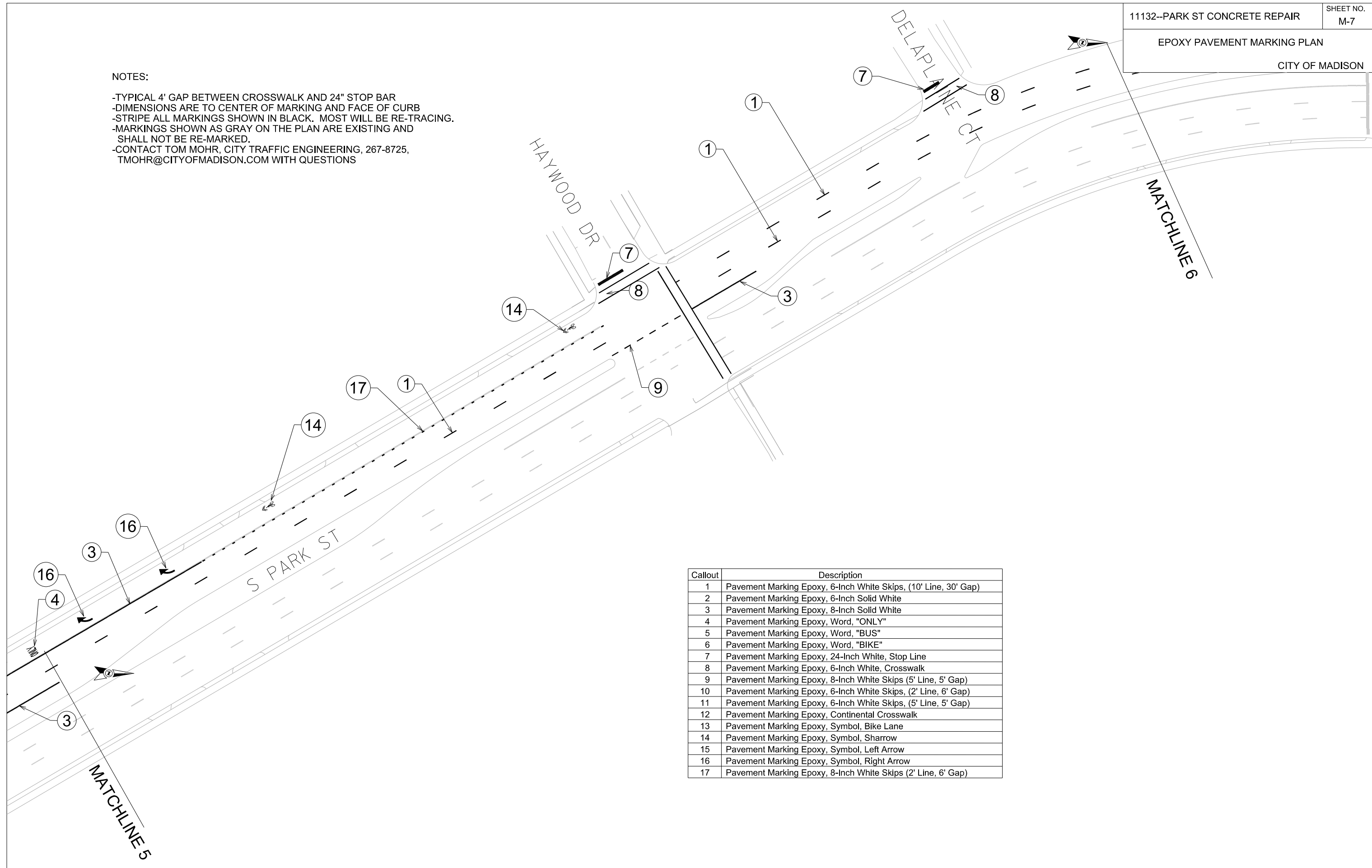

Callout	Description
1	Pavement Marking Epoxy, 6-Inch White Skips, (10' Line, 30' Gap)
2	Pavement Marking Epoxy, 6-Inch Solid White
3	Pavement Marking Epoxy, 8-Inch Solid White
4	Pavement Marking Epoxy, Word, "ONLY"
5	Pavement Marking Epoxy, Word, "BUS"
6	Pavement Marking Epoxy, Word, "BIKE"
7	Pavement Marking Epoxy, 24-Inch White, Stop Line
8	Pavement Marking Epoxy, 6-Inch White, Crosswalk
9	Pavement Marking Epoxy, 8-Inch White Skips (5' Line, 5' Gap)
10	Pavement Marking Epoxy, 6-Inch White Skips, (2' Line, 6' Gap)
11	Pavement Marking Epoxy, 6-Inch White Skips, (5' Line, 5' Gap)
12	Pavement Marking Epoxy, Continental Crosswalk
13	Pavement Marking Epoxy, Symbol, Bike Lane
14	Pavement Marking Epoxy, Symbol, Sharrows
15	Pavement Marking Epoxy, Symbol, Left Arrow
16	Pavement Marking Epoxy, Symbol, Right Arrow
17	Pavement Marking Epoxy, 8-Inch White Skips (2' Line, 6' Gap)

PLOT SCALE:

PLOT NAME:

REV. DATE:

ORIGINATOR: CITY OF MADISON, TRAFFIC ENG. DIV.



NOTES:

- TYPICAL 4' GAP BETWEEN CROSSWALK AND 24" STOP BAR
- DIMENSIONS ARE TO CENTER OF MARKING AND FACE OF CURB
- STRIPE ALL MARKINGS SHOWN IN BLACK. MOST WILL BE RE-TRACING.
- MARKINGS SHOWN AS GRAY IN BLACK. MOST WILL BE RE-TRACING.
- SHALL NOT BE RE-MARKED.
- CONTACT TOM MOHR, CITY TRAFFIC ENGINEERING, 267-8725, TMOHR@CITYOFMADISON.COM WITH QUESTIONS

PLOT SCALE:

PLOT NAME:

REV. DATE:

ORIGINATOR: CITY OF MADISON, TRAFFIC ENG. DIV.

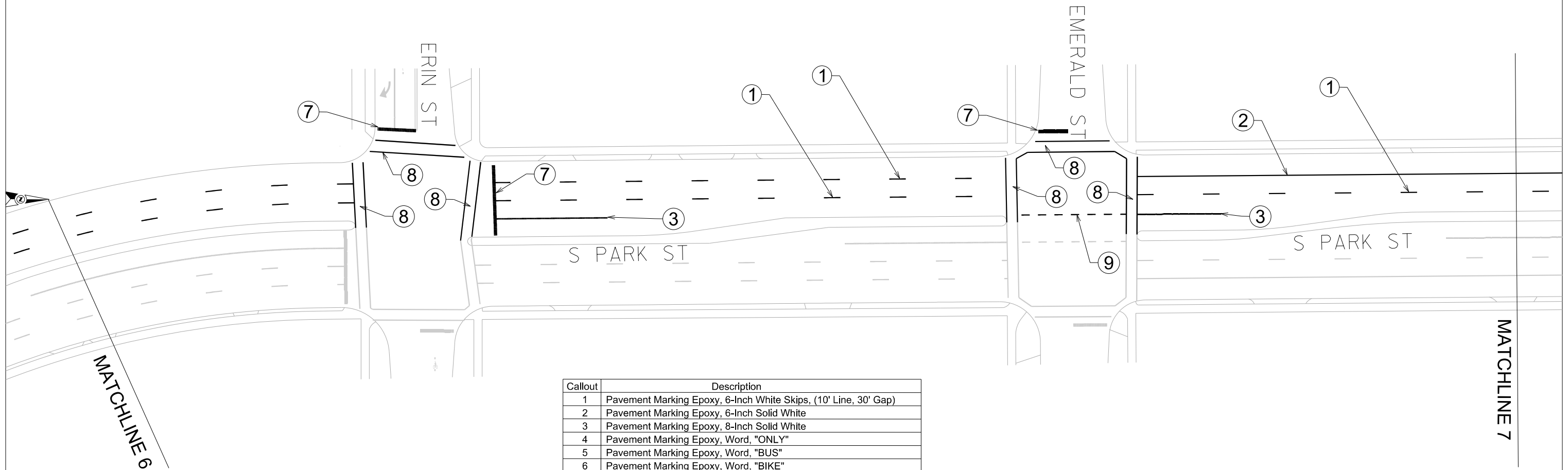

Callout	Description
1	Pavement Marking Epoxy, 6-Inch White Skips, (10' Line, 30' Gap)
2	Pavement Marking Epoxy, 6-Inch Solid White
3	Pavement Marking Epoxy, 8-Inch Solid White
4	Pavement Marking Epoxy, Word, "ONLY"
5	Pavement Marking Epoxy, Word, "BUS"
6	Pavement Marking Epoxy, Word, "BIKE"
7	Pavement Marking Epoxy, 24-Inch White, Stop Line
8	Pavement Marking Epoxy, 6-Inch White, Crosswalk
9	Pavement Marking Epoxy, 8-Inch White Skips (5' Line, 5' Gap)
10	Pavement Marking Epoxy, 6-Inch White Skips, (2' Line, 6' Gap)
11	Pavement Marking Epoxy, 6-Inch White Skips, (5' Line, 5' Gap)
12	Pavement Marking Epoxy, Continental Crosswalk
13	Pavement Marking Epoxy, Symbol, Bike Lane
14	Pavement Marking Epoxy, Symbol, Sharrow
15	Pavement Marking Epoxy, Symbol, Left Arrow
16	Pavement Marking Epoxy, Symbol, Right Arrow





NOTES:

- TYPICAL 4' GAP BETWEEN CROSSWALK AND 24" STOP BAR
- DIMENSIONS ARE TO CENTER OF MARKING AND FACE OF CURB
- STRIPE ALL MARKINGS SHOWN IN BLACK. MOST WILL BE RE-TRACING.
- MARKINGS SHOWN AS GRAY ON THE PLAN ARE EXISTING AND SHALL NOT BE RE-MARKED.
- CONTACT TOM MOHR, CITY TRAFFIC ENGINEERING, 267-8725, TMOHR@CITYOFMADISON.COM WITH QUESTIONS

PLOT SCALE:

PLOT NAME:

REV. DATE:

ORIGINATOR: CITY OF MADISON, TRAFFIC ENG. DIV.

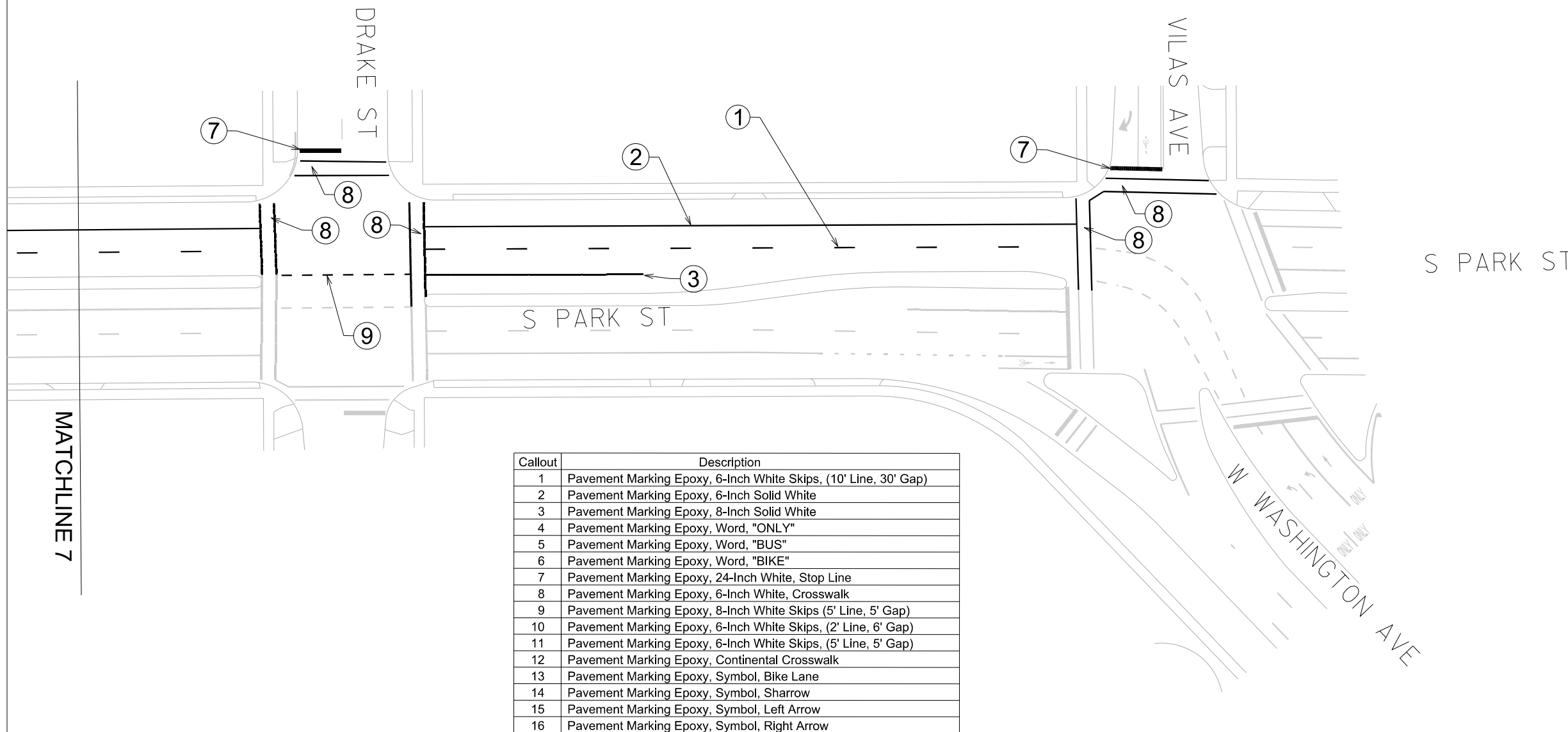

Callout	Description
1	Pavement Marking Epoxy, 6-Inch White Skips, (10' Line, 30' Gap)
2	Pavement Marking Epoxy, 6-Inch Solid White
3	Pavement Marking Epoxy, 8-Inch Solid White
4	Pavement Marking Epoxy, Word, "ONLY"
5	Pavement Marking Epoxy, Word, "BUS"
6	Pavement Marking Epoxy, Word, "BIKE"
7	Pavement Marking Epoxy, 24-Inch White, Stop Line
8	Pavement Marking Epoxy, 6-Inch White, Crosswalk
9	Pavement Marking Epoxy, 8-Inch White Skips (5' Line, 5' Gap)
10	Pavement Marking Epoxy, 6-Inch White Skips, (2' Line, 6' Gap)
11	Pavement Marking Epoxy, 6-Inch White Skips, (5' Line, 5' Gap)
12	Pavement Marking Epoxy, Continental Crosswalk
13	Pavement Marking Epoxy, Symbol, Bike Lane
14	Pavement Marking Epoxy, Symbol, Sharrow
15	Pavement Marking Epoxy, Symbol, Left Arrow
16	Pavement Marking Epoxy, Symbol, Right Arrow